

FREDRICK	011402		1
STREET NAME	ADDRESS	APT. NO.	CARD NO.

# BUILDING PERMIT

INSTRUCTIONS: FILL IN AREA WITHIN HEAVY LINES. USE TYPEWRITER OR BALL POINT PEN. PRESS FIRMLY. BE SURE ALL COPIES ARE LEGIBLE. NO ERASURES PERMITTED. DOUBLE CHECK HE WILL BE CHARGED IF WORK IS STOPPED BEFORE PERMIT IS ISSUED.

DEVELOPMENT SERVICES DEPT., GARDEN GROVE 638-6771

Job Address **11402 FREDRICK GG** Permit No. **073337A**

FIRE ZONE **R-1** OCCUPANCY **J** TYPE **V** OCC. LOAD

Lot No. **18** Tract No. **1512** Blk. No. **11**

USE ZONE **R-1** FRONT LEFT RIGHT NEAR

Owner **ML James Devine** Tel. No. **539 2615**

PARALLEL SPACES (REQUIRED) **71** SETBACKS

Mailing Address **11402 Fredrick GG** City **GG** Zip No. **92670**

PLANNING **EXISTING STRUCTURE**

Arch.  Eng. State Lic. No. Tel. No. City Zip No.

Land Use Approved By **R** Date **1/17/74**

Mailing Address City Zip No.

## FEES AND BONDS etc R

	AMOUNT	BOND	PROVIDED
PARCEL MAP			
W/M DEDICATION			
STREET ROAD			
WATER BOND			
WATER ASSESS. FEE			
FIRE HYDRANT FEE			
BARRETT TREE FEE			
PARK & REC. PERDIST. 1			
DRAIN ASSY. PERDIST. 1			

Contractor **OWNER** Lic. No. Tel. No. City Zip No.

Mailing Address City Zip No.

PRESENT BLDG. USE **SFD.** PROPOSED BLDG. USE **Patio Cover**

Validation **1/14/74** **11 007 11\*\*\*26.00**

Validation **1/14/74** **11 007 11\*\*\*26.00**

DESCRIBE WORK TO BE DONE **PATIO COVER**

NEW  ADDN  ALTER  REPAIR  DEMOLISH

FLOOR AREA (SQ. FT.) **120** NO. OF STORIES NO. OF DWELLING UNITS

Remarks:

I certify that I have read this application and state that the above information is correct. I agree to comply to all City Ordinances and State laws relating to building construction. I certify that in the performance of the above work I shall not employ any person in violation of the Labor Code of California relating to Workmen's Compensation Insurance. I further agree to hold the City of Golden Grove free and harmless from any liability arising out of injury or bodily damage resulting from work performed relevant to this permit.

## INSPECTION RECORD

APPROVAL	DATE	INSPECTOR
Foundation and Location		
Reinforcing		
Roof Shig.		
Rough Frame		
Loth or Drywall		
Plat/Brown Ct.		
Parking		
Landscaping		
Land Use Cond.		
Final	<b>6-18-74</b>	<b>Adm</b>
Utility Release		

CONTRACTORS SIGN BELOW  
I certify that I am a licensed contractor and that my license is in full force and effect.

Contractor By **OWNER-BUILDER** Authorized Agent Date

I certify that I am exempt from the provisions of Ch. 9, Div. 3, B and P Code (Contractor's License Law) because (check one):

I am the owner of the above property and will personally perform the above work.  
 I am the owner of the above property and I will contract to have all of the above work performed by licensed contractors.  
 I am the owner of the above property and will employ persons to perform the above work with wages as the sole compensation. I will furnish insurance for the employees as required by the Labor Code of California.  
**James Devine** (Owner's Signature) **Thad Dadda** (Authorized Agent) Date

VALUATION (NOTE: INCLUDE LAND, MAIL, WIRING, PLUMB., HEAT, ETC) **\$ 3,900.00**

If work is not started within 60 days from date of issue or if abandoned for more than 120 days, this permit will be null and void.

FEES Building Permit **\$ 26.00**

RELOCATION ADDRESS

Plan Check **\$ 13.00**

PRESENT BLDG. ADDRESS

Permit Authorized By **R** Date **1/17/74**

MOVING CONTRACTOR ADDRESS

1 ORIGINAL

**BUILDING PERMIT PLOT PLAN**  
Development Services Department  
CITY OF GARDEN GROVE

JOB ADDRESS <i>11402 Fredrick</i>			PERMIT NO. <i>71337A</i>
ASSESSORS PARCEL NO. <i>18</i>	BLOCK <i>1512</i>	TRACT	
JOB DESCRIPTION (PLEASE CHECK)			
<input type="checkbox"/> New <input checked="" type="checkbox"/> Addition <input type="checkbox"/> Alteration <input type="checkbox"/> Repair <input type="checkbox"/> Move <input type="checkbox"/> Demolish			
OWNER <i>James Devine</i>	DATE <i>6/15/74</i>	APPLICANT <i>Patricia Brown</i>	PERMIT VALUE <i>3400<sup>00</sup></i>

DIMENSION PLOT PLAN COMPLETELY SHOWING ALL STRUCTURES ON THE LOT AND THEIR USE.

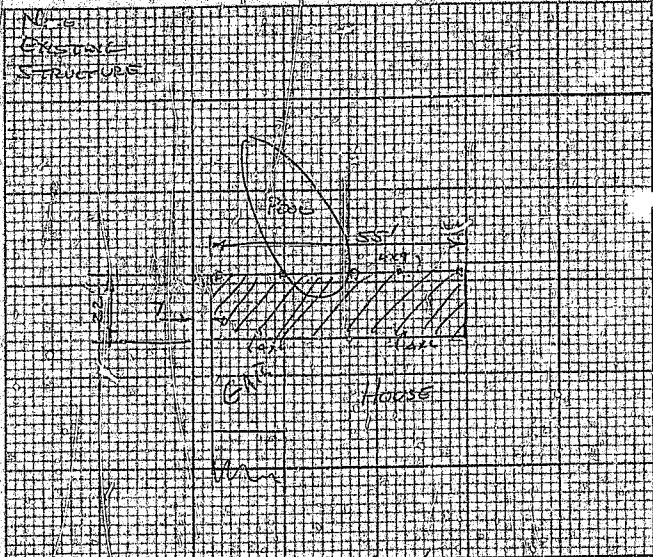

# BUILDING PERMIT

## INSPECTION RECORD

For Applicant to Fill in.

APPROVAL	DATE	INSPECTOR
FOUNDATION & LOCATION		
CONCRETE FLOOR		
REINFORCING		
ROOF SHTG		
ROUGH FRAME		
INSULATION, ENERGY		
LATH OR DRYWALL		
PLAS. BROWN CT		
SOUND INSULATION		
SMOKE DETECTOR		
PARKING		
LANDSCAPING		
LAND USE FINAL		
UTILITY RELEASE		
IDENTIFICATION CODE		
WORKER'S COMPENSATION REQUIREMENTS		
BUSINESS TAX CERTIFICATE INFORMATION		
BUSINESS TAX CERTIFICATE NO.	EXPIRATION DATE	
VALUATION	TOTAL FEES	DATE
ISSUANCE		
BLDG. PERMIT FEE		
ISSUANCE		
VALUATION	TOTAL FEES	DATE
ISSUANCE		

ADDRESS	11402 Fredrick Drive
LOT NO. / BLDG. NO. / TRACT NO. / PERMIT NO.	131245A
OWNER	Robert Mull
TEL. NO.	530-6116
MAILING ADDRESS	
MAILING ADDRESS	
STATE LIC. NO. & TYPE	B-PER 17.00
ISS	10.00
CASH	27.00
CONTRACTOR	OWNER
MAILING ADDRESS	
STATE LIC. NO.	
PROPOSED BLDG. USE	
DESCRIBE WORK TO BE DONE	Replace Existing Redwood Fence Posts and Repair Redwood Sprockets
FLOOR AREA (SQ. FT.)	NO. OF STORIES
NO. OF DWELLING UNITS	
RELOCATION	
MOVING CONTRACTOR	
ADDRESS	

**WORKER'S COMPENSATION REQUIREMENTS**  
 State Compensation Insurance Policy No. \_\_\_\_\_ Expiration Date \_\_\_\_\_  
 I certify that in the performance of the work for which this permit is issued, I shall not employ any person in any manner so as to be exempt subject to the Worker's Compensation laws of California.  
**NOTE:** If, after making such certificate, the applicant for the permit of this code, he shall forthwith comply with the provisions of Section 3700 or his permit shall be deemed revoked.  
 I certify that I have read this application and state that the above information is correct. I agree to comply with all City ordinances and State laws relating to pending construction. I further agree to hold the City of Garden Grove free and harmless from any liability arising out of injury or bodily damage resulting from work performed relevant to the permit.  
 Robert Mull

**BUSINESS TAX CERTIFICATE INFORMATION**  
 I certify that the following Contractor's License No. \_\_\_\_\_ and Classification \_\_\_\_\_ it in full force and effect.  
 (PRINT) CONTRACTOR \_\_\_\_\_ (SIGNATURE) CONTRACTOR OR AUTHORIZED AGENT \_\_\_\_\_ DATE \_\_\_\_\_

**BUSINESS TAX CERTIFICATE NO.** \_\_\_\_\_ **EXPIRATION DATE** \_\_\_\_\_  
 I certify that I am exempt from Section 7031.5 of the Business and Professional Code, Division 3, Chapter 9, Contractors' License Law, under the following Section:  
 Owner, Section 7034.0  Minor work under \$100: Section 7048   
 Employee working for wages only: Section 7053   
 Other: \_\_\_\_\_  
 (PRINT) PROPERTY OWNER (SIGNATURE) PROPERTY OWNER OR AUTHORIZED AGENT \_\_\_\_\_ DATE \_\_\_\_\_

1. INSPECTOR

DATE

INSPECTOR'S NOTES

2/17/83 TALKED WITH MR. MULL ABOVE EXISTING FENCE  
- ASKED IF SHOULD BE REMOVED AND THAT IT WAS  
UNLAWFUL TO CONSTRUCT ON OTHER PROPERTY. A

7/27/83 left at A

9/30/83 MEETING WITH MR. MULL FOR SETTING OF POST HOLES -  
MR. MULL SHOWED ME HIS BORN & BIDE LAND  
PROPERTY LINE MARKER AND THAT THE POST HOLES  
WERE ON HIS PROPERTY - LOCATION  
APPROXIMATE POST HOLES COMPLETED 9/30/83 A

2/16/84 FENCE APPEARS TO BE COMPLETED AND APPEARS TO  
COMPLY, UNABLE TO GAIN ACCESS TO BACK FOR  
INSPECTION OF BACK SECTION. A

OWNER <i>Robert S. Mull</i>	JOB ADDRESS <i>11402 Fredrick Drive</i>	PERMIT NO. <i>13/24524</i>
NAME OF CONSTRUCTION LENDER & BRANCH	ASSESSORS PARCEL NO. LOT <i>40-283-01</i>	BLOCK TRACT
	PLEASE CHECK ONE OR MORE	
	<input type="checkbox"/> New <input type="checkbox"/> Addition <input type="checkbox"/> Alteration <input checked="" type="checkbox"/> Repair <input type="checkbox"/> Move <input type="checkbox"/> Demolish	
ADDRESS	DATE <i>8/10/83</i>	PERMIT VALUE <i>\$500.00</i>
CITY	JOB DESCRIPTION <i>Repair Gopertals + Post Fence</i>	

SHOW NORTH ARROW, PROPERTY LINES AND ADJACENT STREETS.

PROPERTY LINE

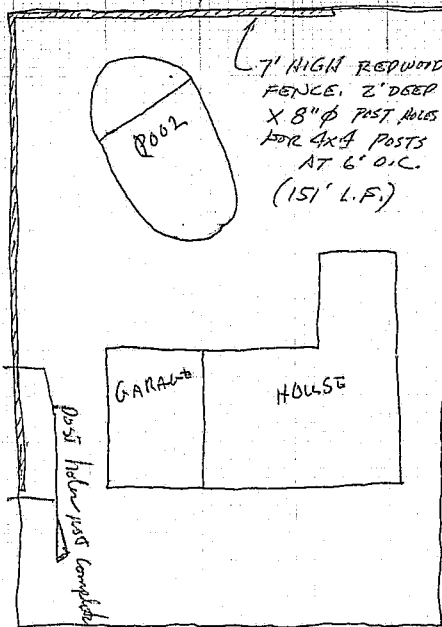

#1 Building Insp./#2 Assessor/#3 Permittee/#4 File  
I certify the information hereon is complete and correct.

PLOT PLAN APPROVED BY \_\_\_\_\_

By \_\_\_\_\_



## PUBLIC WORKS AND DEVELOPMENT DEPARTMENT

## CITIZEN SERVICE REQUEST FORM

#102-83

DATE: 8/4/83 TIME: RECEIVED BY: Joanie

ADDRESS OF PROBLEM: 11402 Frederick ST N

NAME OF OCCUPANT: Robt Mull TELEPHONE: 532-6116

NATURE OF REQUEST:

1. 1/2' grade stack to restore 5' wall  
 2. also build concrete floor  
 property.

OWNER: Robert Rubenstein

NAME OF CALLER: Anony

ADDRESS:

TELEPHONE:

ROUTE TO:  ZONING  BUILDING  OTHER

ASSIGNED TO: BY: DATE:

COMMENTS:

11422 Frederick

8/10/83

Murray Building

PERMITS OBTAIN #131245 A  
 FENCE EAST END TEMP. WILL BE  
 REMOVED IN SEPT. MR. MULL STATED  
 THAT NEIGHBOR APPROVED TIME TABLE  
 FOR PERMITS.

8/15/83

CALLED MR. MORRIS

please

532-4958  
 [Signature]

See Krell



11402 Lot 18 TR 1512

11422 " 17 "

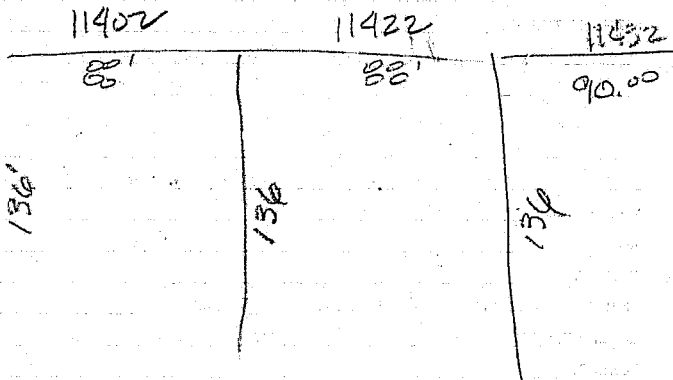

9/19/83  
TH (K&S) will

# INVESTIGATION REPORT

Public Works & Development Department  
11391 Acacia Parkway  
Garden Grove, California 92640

CITY OF  
GARDEN GROVE  
638-6772

JOB ADDRESS 11402 FREDRICK  
Owner MRS. MARY DUNLAP  
Owner's Address WALL

## INSTRUCTIONS

BRING THIS REPORT TO ROOM 220, CITY HALL

- ① REMOVE WOOD FENCE NO LATER THAN DATE BELOW
- ② TO OBTAIN PERMIT FOR FENCE IF ITS TO REMAIN A APPLICATION SHALL BE SUBMITTED TO THE ABOVE DEPARTMENT.
- ③ IDENTIFY, AND DESCRIBE WORK TO BE DONE ON APPLICATION

OCTOBER 4 - 1983

Comply on or before

### PERMITS REQUIRED

Building \_\_\_\_\_ Electric \_\_\_\_\_ Plumbing \_\_\_\_\_ Mechanical \_\_\_\_\_

### SECTION 1.04.010 GARDEN GROVE MUNICIPAL CODE

Any person violating any of the provisions or failing to comply with any of the mandatory requirements of this code is guilty of a misdemeanor. Any person convicted of a misdemeanor under this code shall be punished by a fine of not more than five hundred dollars, or by imprisonment not to exceed six months, or by both such fine and imprisonment. Each such person shall be guilty of a separate offense for each and every day during any portion of which any violation of this code is committed, continued, or permitted by any such person, and he shall be punished accordingly.

I certify that one copy was mailed \_\_\_\_\_

Left at the job address X

Inspector's Signature Ann Thomas

Date 9/20/83

### Violations and Description:

Building

Land Use

VIOLATION OF SECTION 301 (A) OF THE UNIFORM BUILDING CODE (PERMITS REQUIRED) FOR CONSTRUCTION, ENLARGEMENT, ALTER, OR REPAIRS  
DESCRIPTION:  
INSTALLATION OF 6' WOOD FENCE ON PROPERTY AND ATTACHING TO EXISTING BLOCK WALL

PLOT PLAN OR DESCRIPTION



WOOD FENCE →

EXISTING Block wall

Routing 1. Inspector 2. Office 3. Owner